

*signature*  
hotel group limited

Seeing is believing...





# Welcome to Dunchurch Park

## ...The place to meet

"A splendid hybrid of advanced technology and old world charm, where innovative conference and training areas rub shoulders with beautiful formal gardens and woodland in the heart of the Warwickshire countryside."

Dunchurch Park Hotel & Conference Centre is a tranquil, Grade II listed Manor House, set in 72 acres of magnificent gardens and grounds.

Benefiting from an excellent range of facilities, our venue is ideal for meetings, interviews, conferences & training courses, product launches & special events, outdoor activity days & team building exercises, private dining, award dinners and celebrations.

The venue is designed for maximum flexibility, with all meeting rooms looking out over the stunning gardens and grounds and enjoying the benefit of natural daylight.



Within the estate we have a dedicated area for motorised activities as well as large, flat grassed areas and lawns for all types of team building exercises, outdoor activities, and fun days. Not to forget about our very own high and low ropes course hidden amongst the trees.

After a hard day's work, guests can workout in the gym or enjoy some of the outdoor leisure facilities such as the putting green, tennis court, croquet lawn and soccer pitch. Alternatively, guests can simply relax and unwind in one of the lounges, bars or decking and terraced areas.

Or, for the perfect relaxation there is no better way than to visit our on site spa centre for all your health and beauty needs.



## Dunchurch Park Hotel Snapshot

- Centrally located close to M1, M6, M45, M40
- Only 50 minutes from London Euston by train
- Close to Birmingham Airport & NEC
- 24 Conference, meeting and syndicate rooms
- Conference capacity for up to 300 delegates
- Fully equipped Marquee

- All-inclusive delegate packages
- Dedicated conference & events team
- 89 en-suite bedrooms and access to leisure facilities
- Table d'hote restaurant and bistro bar
- 72 acres of gardens and grounds
- Dedicated area for motorised activities
- Extensive complimentary car parking



# Variety and Flexibility ...Training and Meeting facilities

A choice of 24 conference, meeting and training rooms presents Dunchurch Park as an extremely versatile venue.

Mawson's Marquee, located within its own secluded garden, is fully equipped and is ideal for exhibitions & road shows, car &

product launches, private dining celebrations & receptions.

The delegate café areas are open all day for guests to help themselves to unlimited refreshments and substantial snacks.

## ALL INCLUSIVE DELEGATE PACKAGES

### Day Delegate

- Choice of at least 4 different breakfast snacks
- Unlimited refreshments
- Mid morning home baked shortbread
- Chilled still and sparkling mineral water in conference rooms
- Bowl of fresh apples in conference rooms
- LCD projector & screen or LCD plasma screen in conference room
- Flipcharts & pens in all rooms

- 2 Course buffet lunch to incorporate hot dish, vegetarian dish, cold meats & salads and selection of desserts OR:

2 course working lunch delivered to the conference room OR:

"grab & go" where delegates can eat off the 2 course buffet lunch but eat it outside in the grounds or back in their conference rooms.

- Choice of at least 3 different afternoon cakes and / or mini ice cream cones
- Message board outside every conference room
- Personalised welcome pack for trainers

### 24 hour Delegate

As Day Delegate plus:

- Express check-in (for conferences of 10 and above)
- Complimentary drink in the bar between 5-6.30pm (wine, beer or soft drink)
- Three course table d'hôte menu, served either in the Great Hall or in a private dining room (subject to availability)
- Over night accommodation
- Full English breakfast
- Complimentary newspaper

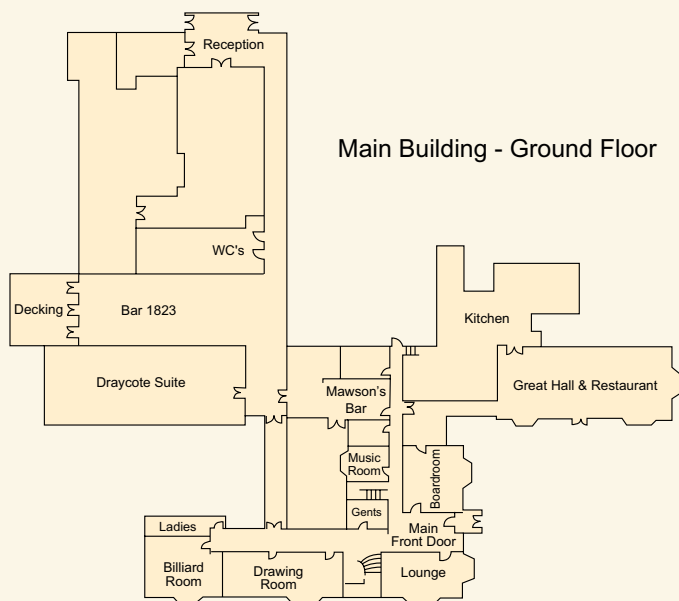

Main Building - Ground Floor

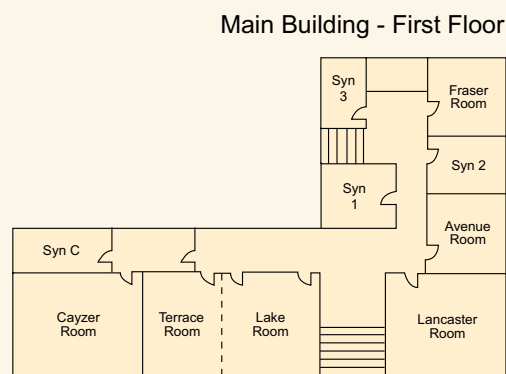

Main Building - First Floor

	BILLIARD ROOM	DRAWING ROOM	MUSIC ROOM	DRAYCOTE SUITE	GREAT HALL	BOARDROOM	LOUNGE	LAKE/TERRACE	CAYZER ROOM	LANCASTER ROOM	AVENUE ROOM	FRASER ROOM
Floor Location	G	G	G	G	G	G	G	1st	1st	1st	1st	1st
U-Shape	16	28	-	26	40	-	16	22	16	16	12	12
Theatre	50	60	-	100	120	-	25	50	35	35	15	20
Cabaret/ Classroom	24	30	-	72	72	-	18	30	20	20	10	10
Boardroom	16	28	10	36	40	14	20	26	15	18	12	14
Dinner	35	50	10	120	130	-	-	-	-	-	-	-
Buffet	35	70	-	120	160	-	-	-	-	-	-	-
Reception	60	90	-	200	200	-	-	-	-	-	-	-
Length in m	9.14	11.58	4.26	19.81	18.15	8.00	7.55	11.27	7.92	7.92	5.48	5.48
Width in m	7.31	5.79	4.26	9.75	9.23	5.32	5.93	4.87	4.87	4.87	5.18	5.48
Area Sq m	66.81	67.04	18.17	193.05	167.52	42.56	44.77	54.88	38.57	38.57	28.30	30.03

Please note that the numbers will depend on what equipment is to be used in the rooms



## Adaptable Spaces in The Garden Rooms

The Garden Rooms at Dunchurch Park Hotel & Conference Centre is a purpose built, self-contained suite of rooms, located within the privacy of the tranquil Victorian walled gardens.

This facility has its own entrance from the car park, reception area and registration desk, cloakrooms, foyer area for refreshment breaks and syndicate room. The main conference room can be subdivided into 2 or 3 rooms with individual access from the foyer.

Accommodating up to 300 delegates theatre style, the plenary room is fully

supported with the latest presentation equipment, surround sound system, air-conditioning, natural daylight and doors that open onto a private patio.

The Garden Rooms is also an ideal venue for private dining, award ceremonies, dinner dances, celebrations, and receptions, and can accommodate up to 180 for a seated meal or 320 for a reception. It has its own bar facilities, a stage for a band or DJ and a portable dance floor.

	*MAIN ROOM	*HIDCOTE/ KIFTSGATE	HIDCOTE	KIFTSGATE	BLenheim	KEW
Floor Location	G	G	G	G	G	G
U-Shape	60	45	22	22	32	16
Theatre	300	180	60	80	100	35
Cabaret/Classroom	150	100	32	32	40	16
Boardroom	70	60	20	30	40	20
Dinner	180	60	-	-	-	-
Buffet	280	180	-	-	-	50
Reception	320	200	-	-	-	-
Length in m	12.49	12.49	12.49	10.36	12.49	7.31
Width in m	20.3	12.8	5.48	7.31	7.31	7.31
Area Sq m	253.54	159.89	68.52	75.78	91.3	53.43

\* Suitable disabled access at all levels

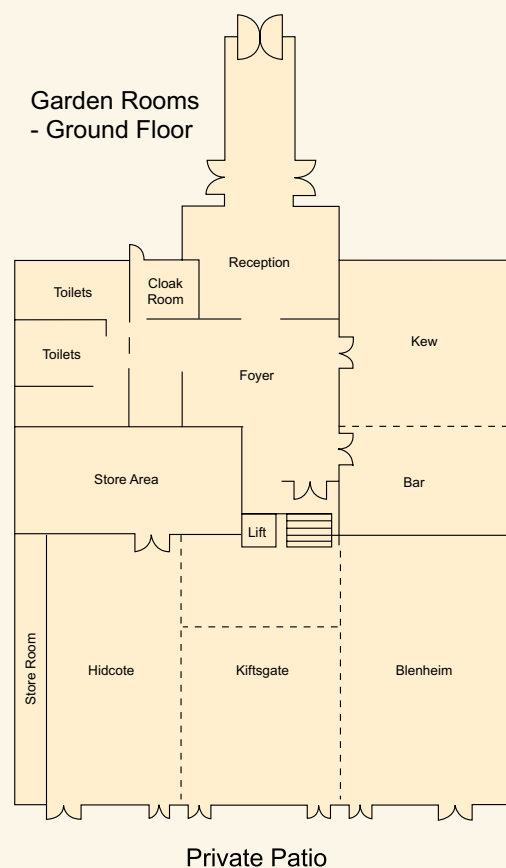



## Fine Food & Surroundings at Dunchurch Park

Our Head Chef and his team have created an excellent range of dishes to select from for your event. You can opt for a set menu or choose from our menu selector. From 3 to 7 course dinners, finger buffets to gala banquets, afternoon teas and picnics to barbeques, we have a selection to suit all requirements.

If you would like to discuss alternative ideas, such as a themed meal or special dietary needs, our chef would be delighted to talk through suggestions with you.

The hotel has a variety of rooms that can accommodate private dining for an intimate group of 10 guests or the Garden Rooms suite and Mawson's Marquee for a party night for up to 350 guests.

Have you considered making your dinner party one to be remembered with entertainment such as a Murder Mystery or Race Night? For those big party nights why not add a theme such as James Bond with casino tables or a night at the Oscars.

To discuss ideas for your event please contact our event co-ordinators.



## Face the Challenge of Corporate Activities & Fun Days

Amongst the 72 acres of grounds at Dunchurch Park there are several locations dedicated to corporate activities and fun days. There is a 5 acre field for driving and shooting activities and large flat grass areas for all types of team building and fun days.

### Multi Activity Events

Typical action orientated events and activities include:

- Crossbow Archery
- Rifle Shooting
- Pistol Shooting
- Sheep Dog Handling
- Quad Bikes
- Longbow Archery
- Laser Clay Pigeon Shooting
- Falconry
- Rage Buggies

### Team Building Events

Team Building Events can also be arranged using the beautiful grounds of Dunchurch Park. The event options could include the following, but essentially the options are tailored by the objectives that you have for your event:

- A Teamwork Challenge
- The Picasso Picture Show
- The Dunchurch Park Treasure Hunt
- Boogie Nights
- Rhythm Factory

### Take the leap...

Hidden away in one of the wooded areas within the grounds there is also our own purpose built, high and low ropes course, designed to develop winning teams and cultivate leadership through challenge and adventure.

### The Original It's a Knockout

Now it is time to get out of your armchair and be one of the teams taking part in the real "It's A Knockout". To cap it all we can also arrange for the original BBC compere, Stuart Hall, to run the event for you providing an added touch of humour and nostalgia.

### School Sports Spectacular

We all remember the days when we competed in the yearly school sports day, wearing our very best pumps and green bib. Now you have a chance to step back in time and participate in events such as the egg and spoon, sack and three legged races.

With so many event options it is very difficult to outline the whole range that is available. Please contact our Events Office who will guide you through everything you need to know.

Working in partnership with:





## Tailored golf packages at Rugby Golf Club



We have recently formed an exclusive new partnership with Rugby Golf Club so that you can enjoy some excellent packages at one of the Midlands finest golf courses.

We can offer tailored golf packages to fit in around your conference at Dunchurch Park Hotel and Conference Centre.

### Rugby Golf Club

Founded in 1891, Rugby Golf Club is a friendly private members club situated in the beautiful Warwickshire countryside.

The undulating parkland course has many unique features such as the towering viaduct that dissects the course, or the brook which meanders through several of the holes, making this a thinking mans course. It has the reputation of a good challenge for all levels of player and is a regular venue for county standard matches. It favours accuracy rather than big hitting.

The course layout is perfect with 2 loops of 9 holes starting and ending at the clubhouse, allowing a quick 9 holes if time is short or perfect for a late evening round. The 9th and 18th are tough finishing holes, with the 18th aptly called 'Wrecker'.

You will be assured of a friendly welcome while visiting our Golf Club and the staff will be only too happy to help you enjoy your

days golf, with a fully stocked professionals shop and trolley and club hire available on request.

A practice putting green and short game area will help you sharpen your game before you play.

Two seater buggies are available for hire.

### Facilities

Clubhouse	Bar/Food	On site parking
Changing/shower facilities	Golf professionals shop	Hire equipment
Putting green	Short-game area	Practice bunker
Meeting Room	Sky TV	



Telephone: 01788 575134 E mail: [info@rugbygolfclub.co.uk](mailto:info@rugbygolfclub.co.uk)



Welcome to

# HEALTH & BEAUTY

at  
*Dunchurch Park*

Sometimes we all need a little treat. So whether you are away on business or have a special event to prepare for, head over to Health & Beauty at Dunchurch Park, our on site health, beauty and relaxation salon.

The contemporary yet sophisticated décor gives the old stable block a fabulous modern look, where you can sit

back, relax and let our highly experienced and dedicated team look after you in our beautifully decorated treatment rooms.

With a whole host of treatments there is something for everyone and if you are looking for a special treatment for two why not book into our exclusive couple's room for ultimate luxury.

## Treatments include:

- Bridal hair and makeup
- Eye beauty
- Sport & deep tissue massage
- Relaxations
- General pampering
- Aromatherapy
- Reflexology
- Reiki
- Indian head massage
- Therapeutic body massage
- Hot and cold stone massage
- Makeup, hair and beauty training academy

You can select from our wide range of standard programmes or create your own selection of treatment – the choice is yours.

Telephone: 01788 810656



**Directions:**

M1 (Northbound) - Exit motorway at junction 17 to join the M45 motorway. At the end of the M45 take the B4429 towards Dunchurch. At the traffic lights in Dunchurch turn left onto the A426. Dunchurch Park is 500 yards on the right.

M6 & M1 (Southbound) - Exit the M1 at junction 20, or the M6 at junction 1. Head for Rugby and then follow the signs for Banbury (A426), Dunchurch is 3 miles from the town centre. Dunchurch Park is 500 yards on the left after entering the village.

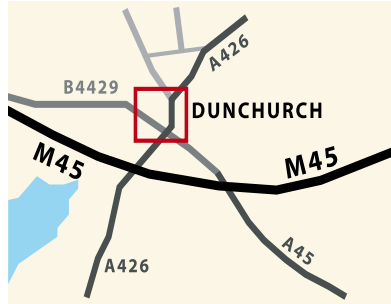

**Location information**

- **Airport** Birmingham 24 miles
- **Railway Stations** Rugby - Intercity 3 miles
- **Motorways**
  - M45, Jct 1 1.5 miles
  - M6, Jct 1 5 miles
  - M1, Jct 18 7 miles
  - M1, Jct 20 10 miles
  - M40, Jct 15 19.5 miles
- **Amenities**
  - Local Shops 0.2 mile
  - Hair Salon 0.2 mile
  - Rugby Golf Club 4 miles
  - Central Shopping 3 miles
  - Leisure Club 4 miles
  - Belgrade Theatre 13 miles

For more comprehensive directional details please visit our website: [www.signaturegroup.co.uk](http://www.signaturegroup.co.uk)

**Contact Us:**

**Dunchurch Park Hotel and Conference Centre**  
**Rugby Road, Dunchurch, Warwickshire CV22 6QW**

Main Switchboard: 01788 810656

Conference Department: 01788 528112

Weddings: 01788 528149



**DUNCHURCH PARK HOTEL & CONFERENCE CENTRE**

Rugby Road, Dunchurch,  
Rugby, Warwickshire CV22 6QW

T: +44(0)1788 810 656

F: +44 (0)1788 813 073

[info@dunchurch.co.uk](mailto:info@dunchurch.co.uk)

[www.signaturegroup.co.uk](http://www.signaturegroup.co.uk)